

DENSO
robotics

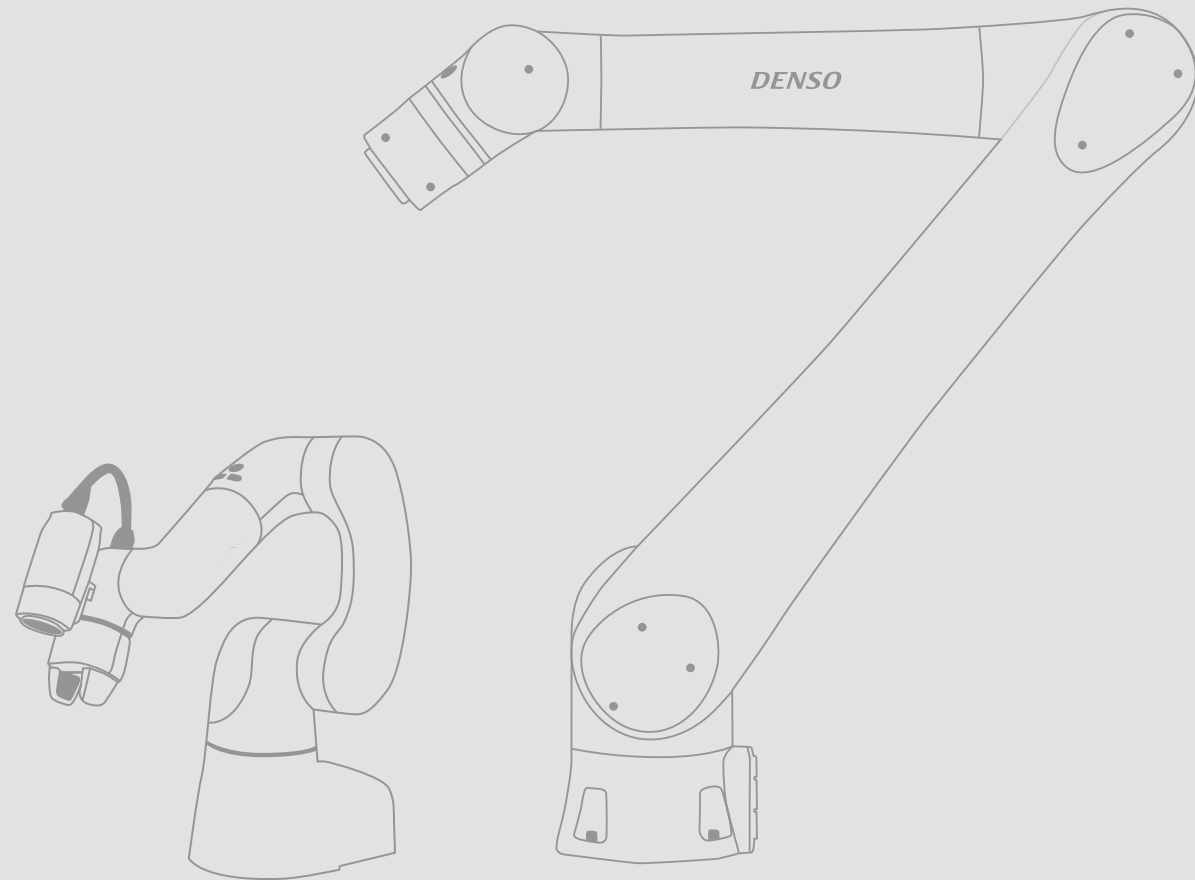

DENSO Robotics
Waldeckerstr. 9
64546 Mörfelden-Walldorf



info@denso-robotics-europe.com



+49(0) 610 527 351 50



denso-robotics-europe.com

DENSO
robotics

COBOTTA-Series

COBOTTA AND
COBOTTA PRO



COBOTTA-Series



	COBOTTA	COBOTTA PRO 900	COBOTTA PRO 1300
Reach	342.5 mm	908 mm	1.303 mm
Payload	0.5 kg (0.7 kg ³)	6 kg	12 kg
Repeatability	± 0.05 mm	± 0.03 mm	± 0.04 mm
Max. TCP speed	450 mm/s	2.100 mm/s ²	2.500 mm/s ²
Protection	IP 30	IP 54 Clean room ISO 5 ¹	IP 54 Clean room ISO 5 ¹
Weight	4 kg	28.5 kg	38 kg
ISO Standards	EN ISO 102181:2011, EN ISO 13849 1:2015, ISO/TS 15066:2016		

¹ Option, ² Maximum TCP speed during high speed operation
³ When the end-effector faces downward (within ±10 °)

By expanding our collaborative product portfolio with our new COBOTTA PRO, which inspires with reaches of up to 1300 mm and maximum loads of up to 12 kg, we offer an ideal solution for almost every application. Work that previously could only be done by humans can now be easily automated.



The COBOTTA PRO was not only developed to facilitate cooperation between humans and robots, but also to continuously maximise productivity. It offers an ideal mix of productivity and safety for both simple tasks and multi-step processes.



Easy to use / Easy to programm

- Direct teach-in, hand guiding modus
- Intuitive programming COBOTTA World visual tablet app
- Easy programming Blockly: flexible visual programming even for high precision & complex tasks



Safe Design

- Power and force limited Cobots
- Inherent safe design & functional safety (TÜV certified)
- COBOTTA PRO: safeguards worker by augmenting proprietary torque sensors
- Option: Touch sensing soft cover to improve productivity safety



Flexibility & High Performance

- COBOTTA: built-in controller, built-in gripper and built-in AF camera (options)
- COBOTTA PRO: Highspeed meets collaboration, TCP up to 2500mm/s
- Track memorization
- Fine adjustment up to 0.1 mm
- Internal wiring (signals & air)